

**Jabra**<sup>®</sup>  
YOU'RE ON

# JABRA BIZ 2400 II



User Manual

[jabra.com/biz2400](http://jabra.com/biz2400)

A BRAND BY

**GN Netcom**

---

© 2014 GN Netcom A/S, GN Netcom US, Inc. All rights reserved. Jabra® is a registered trademark of GN Netcom A/S. All other trademarks included herein are the property of their respective owners. The Bluetooth® word mark and logos are owned by the Bluetooth SIG, Inc. and any use of such marks by GN Netcom A/S is under license.

---

Made in China

TYPE: BIZ2400

FCC ID: BCE-BIZ2400

IC: 2386C-BIZ2400



ICC-CRM-  
GN-BIZ2400



---

**Declaration of Conformity** can be found on  
[www.jabra.com/CP/US/declarations-of-conformity](http://www.jabra.com/CP/US/declarations-of-conformity)

|  |    |
|--|----|
| 1. WELCOME .....                               | 4  |
| 2. JABRA BIZ 2400 II OVERVIEW .....            | 5  |
| 2.1 STEREO VERSION                             |    |
| 2.2 MONO VERSION                               |    |
| 2.3 INCLUDED ACCESSORIES                       |    |
| 2.4 OPTIONAL ACCESSORIES                       |    |
| 3. HOW TO WEAR.....                            | 8  |
| 3.1 ADJUST THE HEADBAND                        |    |
| 3.2 ADJUST THE MICROPHONE                      |    |
| 3.3 CHANGE THE WEARING STYLE                   |    |
| 4. HOW TO CONNECT.....                         | 11 |
| 4.1 CONNECT TO PC                              |    |
| 4.2 CONNECT TO MOBILE DEVICE (USING BLUETOOTH) |    |
| 5. HOW TO USE .....                            | 13 |
| 5.1 EVERYDAY USE                               |    |
| 5.2 MULTIPLE CALL HANDLING                     |    |
| 6. SOFTWARE .....                              | 16 |
| 6.1 JABRA DIRECT                               |    |
| 6.2 PROGRAMMABLE BUTTONS                       |    |
| 6.3 UPDATE HEADSET FIRMWARE                    |    |
| 7. SUPPORT .....                               | 17 |
| 6.1 FAQ  |    |
| 6.2 HOW TO CARE FOR YOUR HEADSET               |    |
| 8. TECHNICAL SPECIFICATIONS .....              | 18 |

# 1. WELCOME

Thank you for using the Jabra Biz 2400 II. We hope you will enjoy it!

## **JABRA BIZ 2400 II FEATURES**

- Hi-Fi audio
- Noise canceling microphone
- Bendable 'Freespin' boom arm
- Safetone hearing protection
- Programmable buttons
- Connects to mobile devices using Bluetooth
- Voice prompts

# 2. JABRA BIZ 2400 II OVERVIEW

## 2.1 MONO VARIANT

---

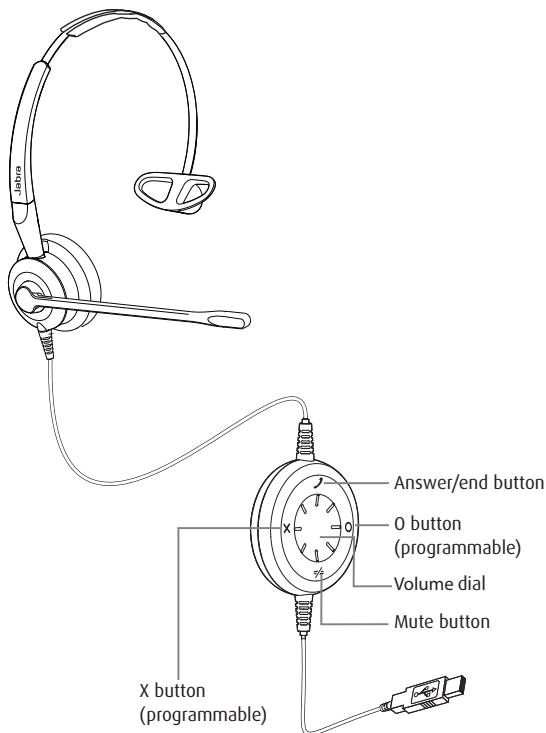

## 2.2 STEREO VARIANT

---

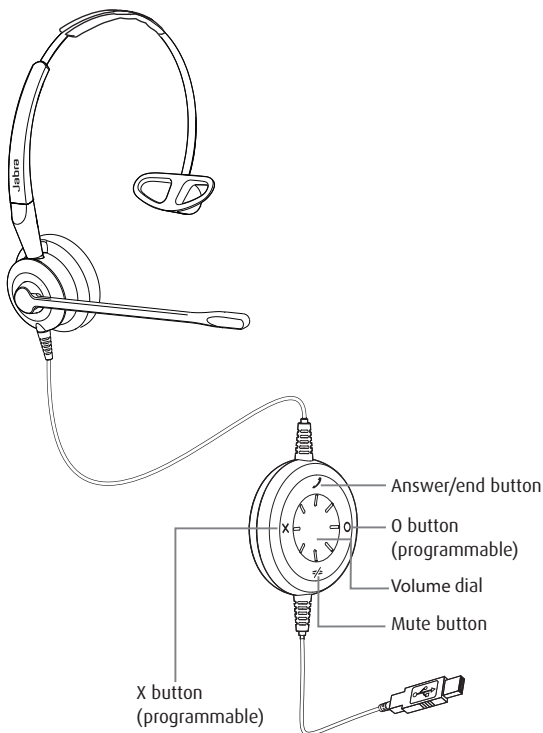

## 2.3 INCLUDED ACCESSORIES

---



Neckband



Headband

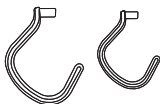

Earhooks  
(small & medium)



Leatherette ear  
cushion (medium)

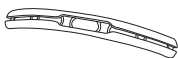

Headband cushion

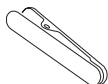

Clothing clip



Carry pouch

## 2.4 OPTIONAL ACCESSORIES

---



Eargels



Leatherette ear  
cushion (large)

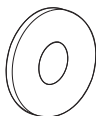

Foam ear cushion (large)

## 3. HOW TO WEAR



### 3.1 ADJUST THE HEADBAND

---

Adjust the headband to find the most comfortable fit.

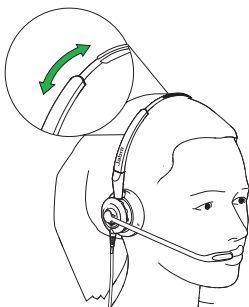



## 3.2 ADJUST THE MICROPHONE

---

It is recommended to position the microphone close to your mouth (approx. two fingers width).

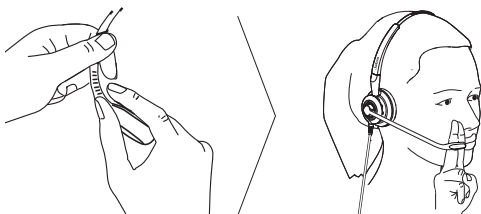

The microphone is bendable for personal preference.

### 3.3 CHANGE THE WEARING STYLE

The headset can be worn in three different wearing styles: headband, earhook and neckband.



#### EARHOOK

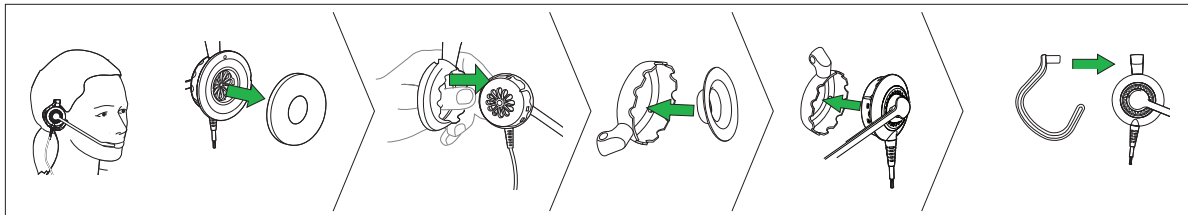

#### NECKBAND

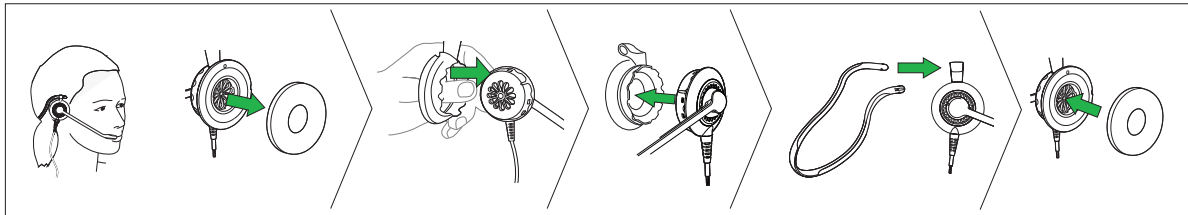

#### HEADBAND

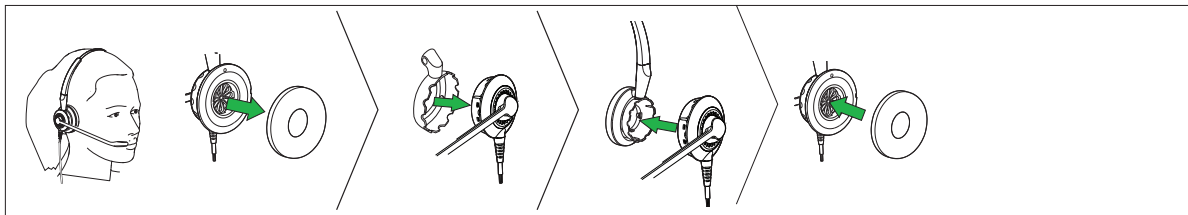

# 4. HOW TO CONNECT

## 4.1 CONNECT TO PC

---

Simply plug the headset into any USB port on the PC.

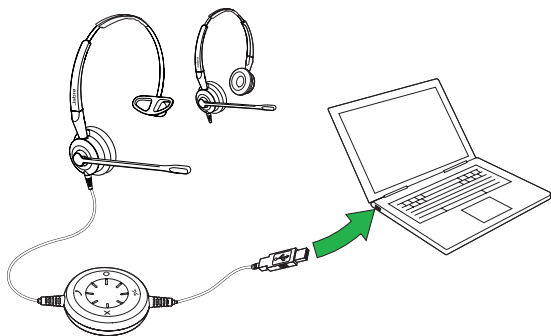

## 4.2 CONNECT TO MOBILE DEVICE (USING BLUETOOTH)

---

1. Plug the headset into any USB port on the PC.
2. Press and hold (5 secs) the **O** button on the controller until the lights turn blue. The headset will now be able to connect to a mobile device.
3. Go to the Bluetooth menu on your mobile device and select the headset from the list of available devices to connect with.

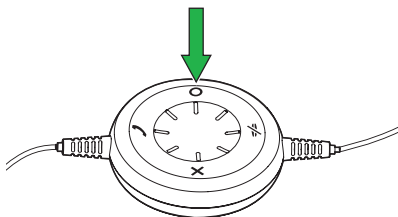



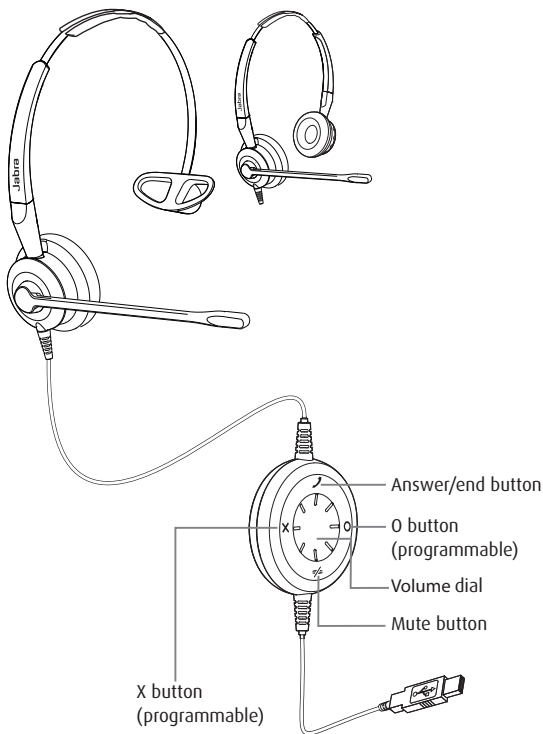

## 5. HOW TO USE



## 5.1 EVERYDAY USE

---

| CALLS  |                           |   |
|--|---------------------------|---|
|   | Answer/end PC call        | Tap the <b>Answer/end</b> button        |
|  | Reject PC call            | Double-tap the <b>Answer/end</b> button |
|   | Answer/end Bluetooth call | Tap the <b>O</b> button*                |
|  | Reject Bluetooth call     | Double-tap the <b>O</b> button*         |
|   | Adjust speaker volume     | Rotate the <b>Volume</b> dial           |
|  | Mute/unmute microphone    | Tap the <b>Mute</b> button              |

\* the headset must be connected to your mobile device as instructed in the 'How to Connect' section 4.2.

## 5.2 MULTIPLE CALL HANDLING

---

The headset can accept and handle multiple calls at the same time.

### MULTIPLE CALLS



---

End current call and answer incoming call

Tap the **Answer/end** button

---

Switch between held call and active call

Press and hold (2 secs) the **Answer/end** button

---

Put current call on hold and answer incoming call

Press and hold (2 secs) the **Answer/end** button

---

Reject incoming call, when on a call

Double-tap the **Answer/end** button

---

# 6. SOFTWARE

## 6.1 JABRA DIRECT

---

Jabra Direct is software designed to support, personalize, manage and enable optimal functionality for all Jabra devices. You can update firmware, change headset preferences and more.

**Download the latest version - [jabra.com/direct](https://jabra.com/direct)**

## 6.2 PROGRAMMABLE BUTTONS

---

The headset buttons can be programmed for other functions using Jabra Direct. Change the Button Configurations in the Device Settings menu.

## 6.3 UPDATE HEADSET FIRMWARE

---

Updating firmware improves performance or adds new functionality to your Jabra headset. Download and install Jabra Direct to enable firmware updating.

You will automatically receive a prompt in Jabra Direct when a firmware update is available for download.



# 7. SUPPORT

## 7.1 FAQ

---

View the FAQs on [Jabra.com/biz2400](http://Jabra.com/biz2400)

## 7.2 HOW TO CARE FOR YOUR HEADSET

---

- Always store the headset safely protected.
- Avoid storage at extreme temperatures (above 70°C/158°F or below -40°C/-40°F). This may adversely affect the headset.

## 8. TECHNICAL SPECIFICATIONS

| JABRA BIZ 2400 II HEADSET    | SPECIFICATION  |
|------------------------------|--|
| Headset weight:              | Mono headset: 54 g<br>Stereo headset: 77 g   |
| Headset dimensions:          | Mono headset: L 139 mm x W 27 mm x H 167 mm<br>Stereo headset: L 133 mm x W 27 mm x H 169 mm |
| Microphones:                 | Noise cancelling microphone  |
| Speaker:                     | 30 mm Dynamic PureSound speakers (Hi-fi)   |
| Speaker maximum input power: | 20 mW  |
| Speaker frequency range:     | Hybrid: 120 Hz - 4500 Hz<br>Wideband: 100 Hz - 6500 Hz<br>USB: 60 Hz - 1600 Hz               |
| Operating temperature:       | -20°C to 60°C (-4°F to 140°F)  |
| Storage temperature:         | -40°C to 70°C (-40°F to 158°F)   |

